

High Frequency Off Grid Solar Inverter

PV1800 Series (8KW-10KW)



Features

- Pure sine wave inverter
- Configurable input voltage range for home appliances and personal computers via LCD setting
- Configurable battery charging current based on applications via LCD setting
- Configurable AC/Solar Charger priority via LCD setting
- Compatible to mains voltage or generator power
- Auto restart while AC is recovering
- Overload/ Over temperature/ short circuit protection
- Smart battery charger design for optimized battery performance
- Cold start function
- WiFi remote monitoring (optional)

Introduction

This is a multi-function inverter/charger, combining functions of inverter, solar charger and battery charger to offer uninterruptible power support with portable size. Its comprehensive LCD display offers user-configurable and easy-accessible button operation such as battery charging current, AC/solar charger priority, and acceptable input voltage based on different applications.

Back panel printing description

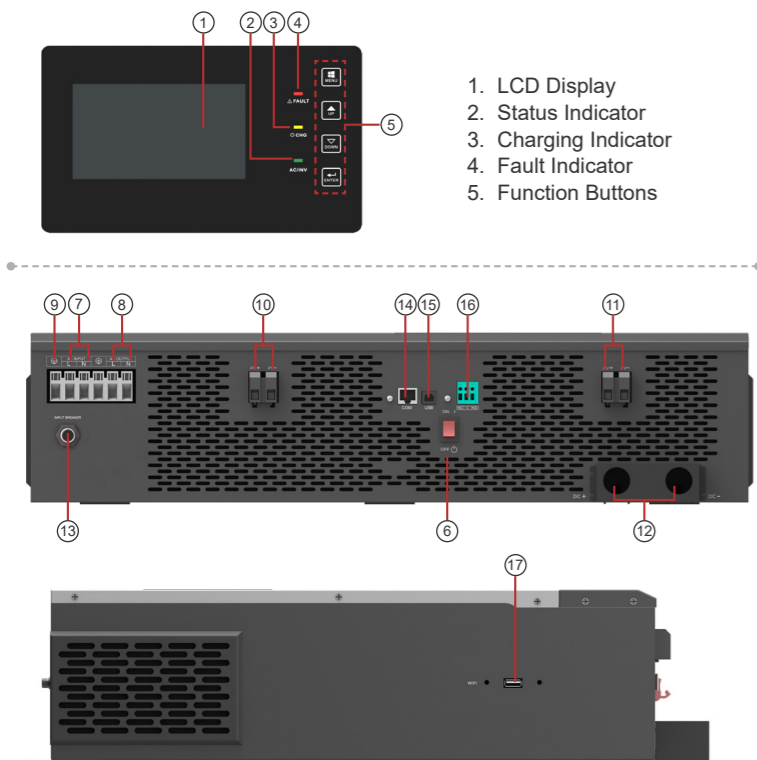

- | | |
|------------------------|-------------------------------|
| 6. Power On/Off Switch | 12. Battery Input |
| 7. AC Input | 13. Circuit breaker |
| 8. AC Output | 14. RS-485 Communication port |
| 9. Ground | 15. USB |
| 10. PV1 Input | 16. Dry Contact |
| 11. PV2 Input | 17. WiFi port (optional) |

Solar system connection

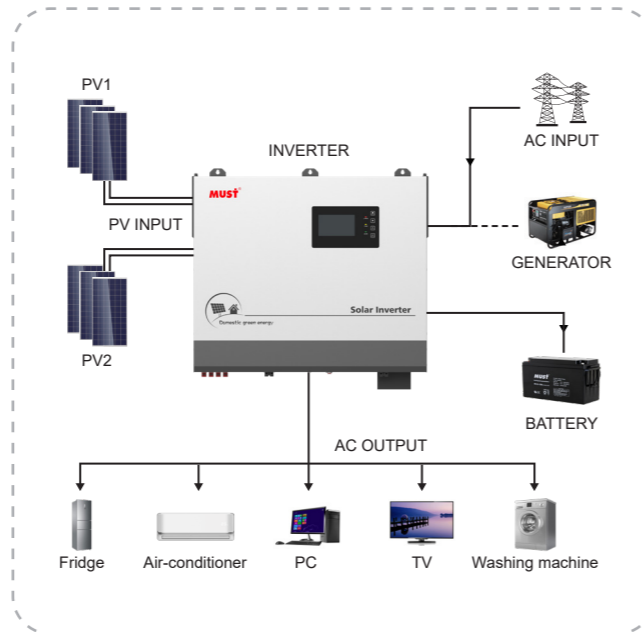

Specification

MODEL		PV18-8048	PV18-10048
Nominal Battery System Voltage		48VDC	
INVERTER OUTPUT	Rated Power	8000W	10000W
	Surge Power	16000W	20000W
	Waveform	Pure Sine Wave	
	AC Voltage Regulation (Batt.Mode)	230VAC±5%	
	Output Frequency	60Hz or 50Hz	
	Inverter Efficiency(Peak)	93%	
	Transfer Time	10ms (UPS) 20ms (APL)	
	AC INPUT	Nominal Input Voltage	230VAC
Max AC Input Voltage		300VAC	
Selectable Voltage Range		170~280VAC (UPS) / 90~280VAC (APL) / 184~253VAC(VDE4105)	
Frequency Range		50Hz / 60Hz(Auto detection)	
BATTERY	Normal Voltage	48VDC	
SOLAR CHARGER & AC CHARGER	AC Charging Current	2-120A	
	Maximum PV Array Open Circuit Voltage	145VDC	
	PV Array Open Circuit Voltage	60-130VDC	
	Cold Start Voltage	46VDC	
	Solar Charging Current	160A	
	Default Charging Current	160A	
	Maximum Charge Current	280A	
MECHANICAL SPECIFICATIONS	Machine Dimensions(W*H*D)(mm)	503*600*141.2	
	Net Weight(kg)	21.0	
OTHER	Safety Certification	CE	
	Operating Temperature	0°C~50°C	
	Storage Temperature	-15°C ~60°C	